



ERINVALE ESTATE
HOTEL & SPA

CONFERENCE & BANQUETING
RATES & PACKAGES



2019

1 Erinvale Avenue, Somerset West, 7130
P. O. Box 2941, Somerset West, 7129, South Africa

Tel: +27 21 847 1160
Fax: +27 21 847 1169

conf@erinvale.co.za
www.erinvale.co.za



ERINVALE ESTATE
HOTEL & SPA



WELCOME

“The Erinvale Estate Hotel & Spa’s conferencing co-ordinators extend a warm and friendly welcome to all conference organisers and delegates.”

CONFERENCING & BANQUETING AT ERINVALE

Embraced by history, surrounded by the majestic Hottentots Holland mountains and neighbouring the magnificent Erinvale Golf Course, the hotel provides the ideal conferencing and banqueting venue.

As a hotel resident, delegates may take advantage of our preferential rates at the Erinvale Golf Course, visit the neighbouring wine estates of Vergelegen, Morgenster and Lourensford or visit the many wine route venues close by. The hotel is situated in Somerset West in the heart of the Winelands only 20 minutes from the historic Stellenbosch, 30 minutes from Cape Town International Airport and 55 minutes via the N2 to Cape Town CBD.

The Erinvale Estate Hotel & Spa offers five air-conditioned divisible conference venues and breakaway rooms, which can cater for conferences, product launches, cocktail functions, banquets or gala dinners. The venues are elegantly furnished rooms with comfortable seating configurable to any requirements.

SERVICES

The banqueting team, supported by the hotel’s food and beverage team, is a dedicated team of professionals and are experienced in handling weddings and functions efficiently and creatively.

STANDARD CONFERENCE EQUIPMENT

Equipment includes: Sharp VHS VS High quality public address system with 1 cordless microphone as well as a lectern, adjustable flipchart, screen, data projector and internet connectivity. Additional equipment can be hired on request. Photocopying and facsimile services are also available on request.

CONFERENCE CENTRE LAYOUT

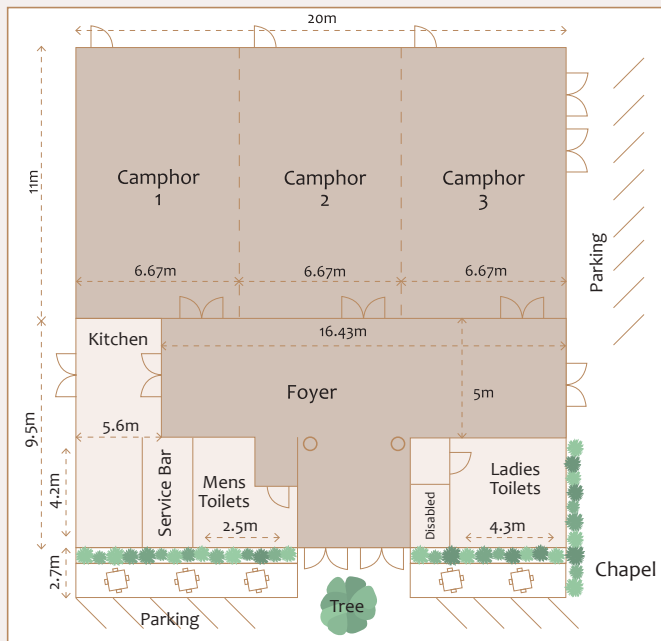

BIRCH AND OAK LAYOUT

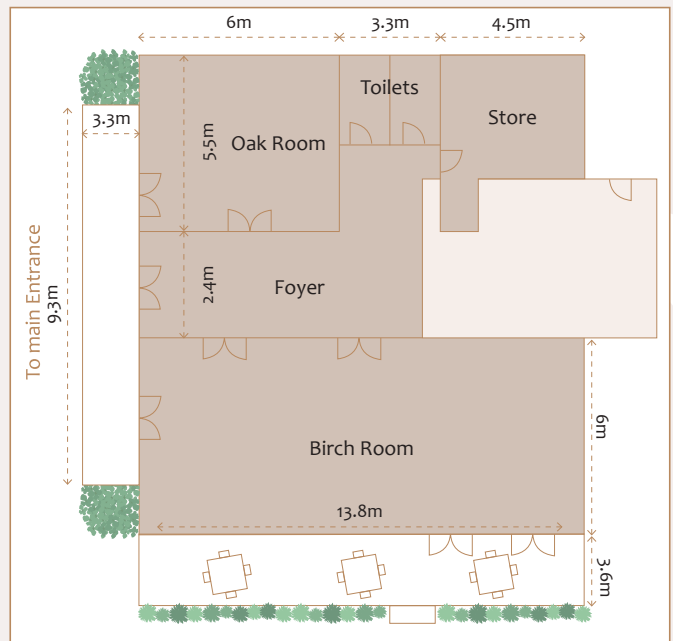

VENUE STATISTICS

	Camphor 1, 2 & 3 (Individual)	Camphor 1 & 2 / 2 & 3	Camphor 1, 2 & 3 (Combined)	Oak	Birch
SEATING CAPACITIES					
U-shape	25	40	50	10	20
School Room	45	70	150	10	20
Theatre	65	130	190	30	40
Banquet	50	120	160	-	-
Dinner-Dance	40	80	150	-	-
Cocktail party	80	150	190	30	-
Boardroom	20	30	40	15	20
DIMENSIONS (m)					
Length	11	11	20	6	14
Width	6.6	13.2	11	5.5	6
Height	3	3	3	3	3
Area (m ²)	72.6	145.2	220	33	84
LIGHTING FACILITIES					
Controls	Y	Y	Y	Y	Y
Dimmers	Y	Y	Y	Y	Y
Windows	Y	Y	Y	Y	Y
Blackout	Y	Y	Y	Y	Y
POWER Sockets	3	6	12	2	3
DOOR Height	2	2	2	2	2
Width	1.7	1.7	1.7	1.8	1.8
SCREENS Height	2	2	2.5	1.8	1.8
Width	2	2	2.5	1.8	1.8



CONFERENCE - RATES AND PACKAGES

DAY CONFERENCE PACKAGE

Our Day Conference Package is R580 per person per day.

This package includes the following:

- Coffee and tea served with rusks on arrival
- Mid-morning coffee and tea served with eats
- Three-Course Lunch
- Afternoon coffee and tea served with biscuits
- Mineral water; mints/sweets; notepaper and pens on the table.

Half Day Conference including lunch: R530 per person per day

Half Day Conference excluding lunch: R400 per person per day

Please see venue hire fees for 1 February, 2019, to 31 January, 2020, below:

Camphor 1, 2 & 3—combined	R18,000
Camphor 1, 2 & 3—individually	R8,000
Oak Room	R4,000
Birch Room	R7,000

All dietary requirements should be arranged prior to the conference. Lunch and dinner menus are as per Chef's choice, unless alternative arrangements are made with our catering team. Requests over and above the standard menu prices, including requests for Halaal and Kosher catering, warrant an applicable surcharge.



ERINVALLE ESTATE

HOTEL & SPA

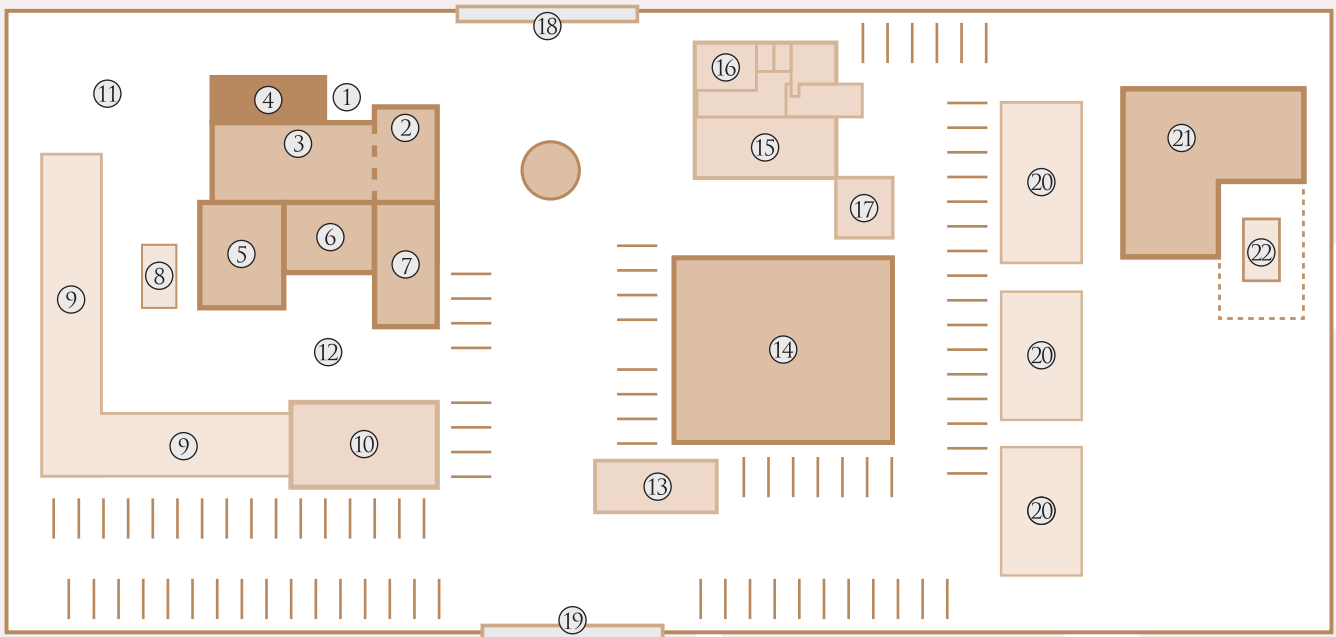

- | | | | |
|-----------------|-------------------|-----------------------|----------------------|
| 1. Manor House | 7. Kitchen | 12. Courtyard | 17. Salon |
| 2. Reception | 8. Pool | 13. Chapel | 18. Main Entrance |
| 3. Lounge | 9. Block A Rooms | 14. Conference Centre | 19. Back Entrance |
| 4. The Terrace | 10. Block B Rooms | 15. Birch Room | 20. Block C Rooms |
| 5. Skelligs Pub | 11. Rose Garden | 16. Oak Room | 21. The Erinvale Spa |
| 6. Seventeen 07 | | | 22. The Spa Pool |

DIRECTIONS

- Take Broadway Boulevard off-ramp (R44) marked Exit 43.
- Turn left at the top of off-ramp.
- At traffic lights (Lord Charles Hotel) turn right into Main Road.
- Turn left at the 4th set of traffic lights into Lourensford Road.
- Follow Lourensford Road for approximately 4 km.
- Turn left immediately after the Erinvale Golf Course.
- Turn right into Erinvale Estate Hotel & Spa.

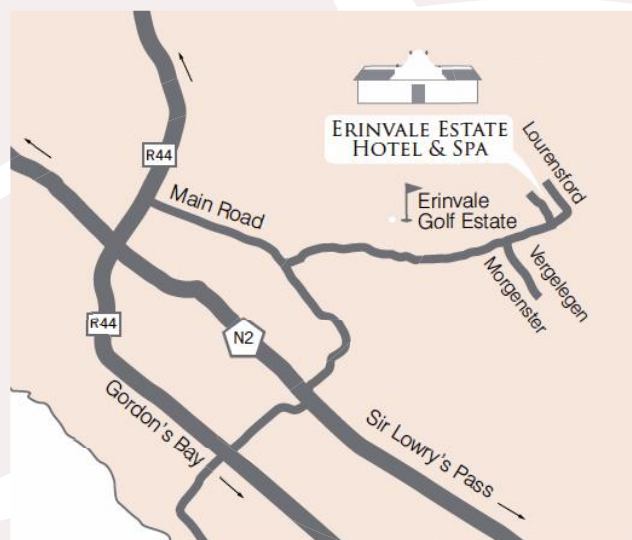

TEAM BUILDING AT ERINVALE - 'THE HEART OF THE HELDERBERG'



VERGELEGEN ESTATE:

Wine tasting, cellar tours, homestead and library cultural tour.

winetasting@vergelegen.co.za
021 847 1334

LOURENSFORD ESTATE:

Chocolate and wine pairings, Sunday and Friday Twilight Markets (seasonal), nature hikes by appointment, art galleries, Millhouse Kitchen, coffee roastery.

winetastings@lourensford.co.za
021 847 2200

MORGENSTER:

Olive, olive oil and wine tasting and cellar tours.

info@morgenster.co.za
021 852 1738



A ROUND OF GOLF

Play a round of golf on the Gary Player-designed 18-hole golf course, renowned throughout the golfing fraternity both locally and abroad.

Pro-shop@erinvale.com
021 847 1144

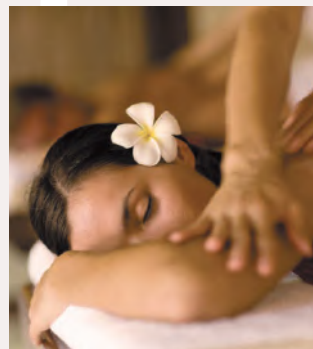

A PAMPERING AT THE SPA

Erinvale Estate Spa, situated on the hotel property, is operated by Lurra Spa. Spa facilities include: four treatment rooms, steam room, indoor heated whirlpool, outdoor pool, relaxation area and sun deck.

spa@erinvale.co.za
021 847 1682

EVENT MANAGEMENT COMPANIES TO ASSIST YOU – ALL AVAILABLE ON THE ERINVALE ESTATE HOTEL & SPA GROUNDS

Dynamic Corporate Activities

- Movie Making
- Survivor Team Challenge
- Frog Derby
- Mini Sports
- Scrabble Matics
- Archery
- Maze Craze – and lots more!

www.corporateactivities.co.za, 086 147 6877

TriActive

- Boere Sport
- Archery
- Drumming
- Gladiator Games
- Murder Mystery
- Potjie Cook Off
- Treasure Hunt – and lots more!

www.triactive.co.za, 021 844 0975

